

FOR LEASE

Space at 88,646 SF Neighborhood Center

St. John Crossing

ST. CHARLES ROCK ROAD & ORLANDO AVE.



**FOR LEASE
1,400 SF**

Site At-A-Glance

- ◆ Anchored by Shop N Save with an Applebee's family restaurant on the outlot
- ◆ Newly developed retail center in densely populated residential area offering over 88,000 square feet
- ◆ St. Charles Rock Road at Orlando Ave. Daily Traffic Count: 27,367
- ◆ Just 1 mile west of I-170

Population	253,508
Households	105,188
Avg. Household Income	\$56,129

5 MILE

Population	89,407
Households	37,730
Avg. Household Income	\$44,312

3 MILE

Population	17,618
Households	7,265
Avg. Household Income	\$44,003

1 MILE

SITE

See Reverse for Site Plan



For more information
please contact:

Sansone Group
120 S. Central
St. Louis, MO 63105

Grant Mechlin or Mark Kornfeld
gmechlin@sansonegroup.com
mkornfeld@sansonegroup.com

p) 314.727.6664
f) 314.727.6101

www.sansonegroup.com



Guiding Visionary Properties sm

OFFICE

INDUSTRIAL

RETAIL

FOR LEASE

St. John Crossing

Tenants

Bay	Tenant	Square Feet
A	Shop N Save	66,244
1	Sun Loan Company	2,232
2	US Cellular	1,400
3	J Nails	1,400
4	EB Games	1,400
5	Liberty Tax Service	1,400
6	Green Moon restaurant	1,400
8	Rainbow Apparel	4,200
10	DaVita, Inc.	2,800
12	Available	1,400
13	Little Caesar's Pizza	1,400
14	Tomorrow Beauty Supply	3,168
55	Applebee's	5,500

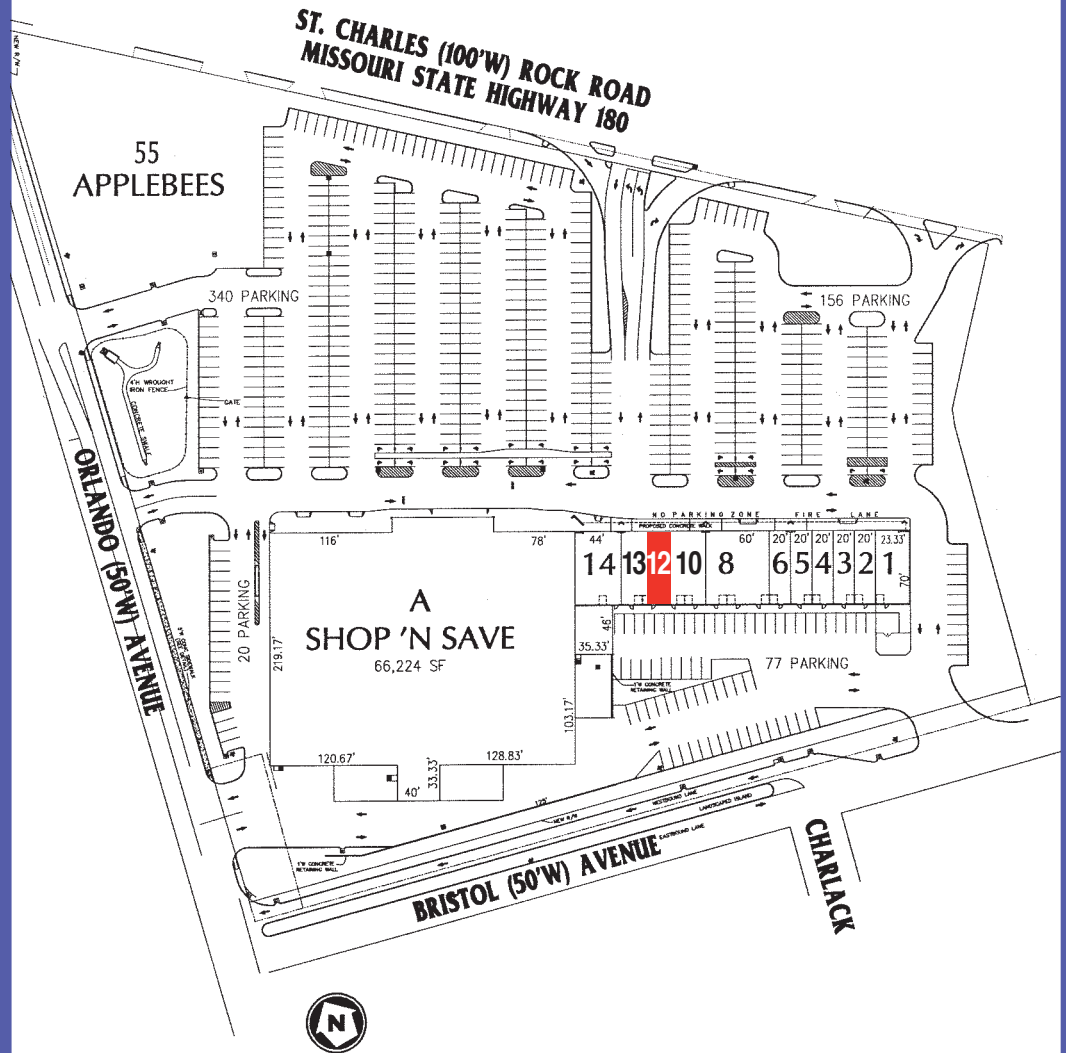

The information contained herein is not warranted, although it has been obtained from the owner of the property or from other sources that we deem reliable. It is subject to change without notice. Seller and broker make no representation as to the environmental condition of the property and recommend purchaser's independent investigation.

www.sansonegroup.com



Grant Mechlin or Mark Kornfeld
 gmechlin@sansonegroup.com
 mkornfeld@sansonegroup.com

p) 314.727.6664
 (f) 314.727.6101

Sansone Group
 120 S. Central
 St. Louis, MO 63105