

FOR LEASE

53,000 Square Foot Multi-Tenant Center

Richardson Crossing

3589 ST. JOHN'S CHURCH ROAD • ARNOLD, MO



Retail At-A-Glance

- ❖ Anchored by Missouri Baptist University and Davita Dialysis
- ❖ 53,000 Square Foot Multi-Tenant Property for Lease with one Outparcel for Sale or Lease
- ❖ Easy Access to Highway 55
- ❖ Abundant Parking Spaces
- ❖ 4,000 Square Feet of Contiguous Space

See Reverse for Site Plan

930-4,000 SF
Available
Outparcel
For Sale or Lease

2009 Est. Population	92,683
Households	33,074
Avg. Household Income	\$76,032

5 MILE

2009 Est. Population	47,170
Households	17,023
Avg. Household Income	\$71,616

3 MILE

2009 Est. Population	7,263
Households	2,594
Avg. Household Income	\$72,050

1 MILE

SITE



For more information
please contact:

Sansone Group
120 S. Central
St. Louis, MO 63105

Mark Kornfeld

mkornfeld@sansonegroup
p) 314.727.6664 • (f) 314.727.6101
www.sansonegroup.com

Guiding Visionary Properties SM

OFFICE

INDUSTRIAL

RETAIL

Tenant Index

Bay	Tenant	Sq. Ft.
100-104	DaVita	4,740
106	Available	930
108	Swe 4U	1,400
110-112	USA Mortgage	2,800
114	AA Nails	1,400
116-118	Contours Express	2,800
120-122	Available	2,590
124	Arnold Smiles	1,610
126	Shelter Insurance	1,190
128	St. Louis Pizza & Wings	1,610
130-132	Available	4,000
136-142	Missouri Baptist University	7,520
148	Available	3,650
150-152	Available	2,800
154-156	Gi-Gi's	3,150
158-162	Arnold Physical Therapy	2,450
164-166	Available	2,800
168-170	Celeslie's Salon & Spa	3,500



Outlot	Tenant
Lot 1B	Culver's
Lot 1C	Available
Lot 2	SOLD - Regions Bank

The information contained herein is not warranted, although it has been obtained from the owner of the property or from other sources that we deem reliable. It is subject to change without notice. Seller and broker make no representation as to the environmental condition of the property and recommend purchaser's independent investigation.



www.sansonegroup.com

Richardson Crossing

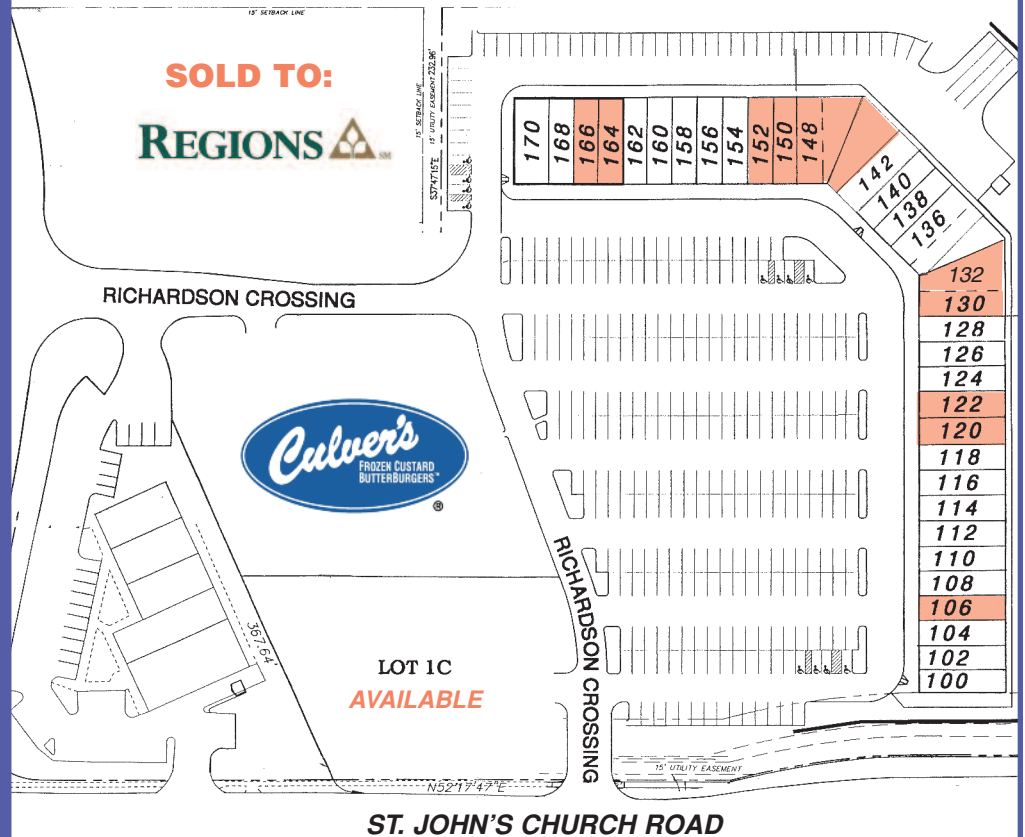

For more information please contact:
Sansone Group
120 S. Central
St. Louis, MO 63105

Mark Kornfeld
mkornfeld@sansonegroup.com
p) 314.727.6664
f) 314.727.6101