

For Lease - Approximately 66,997 RSF



4240 Rider Trail • Earth City, MO 63045

PROPERTY FEATURES:

- 66,997 SF office/warehouse with built-to-suit office space
- 4,000 amp electrical service
- 33' clear ceiling height
- 10 docks with seals and load levelers
- Rail spur available (currently incentive)
- Wet sprinkler system
- Located in the Earth City Business Park with unparalleled access to Interstates I-70 and I-270

**Lease Price:
\$2.50 PSF NNN**

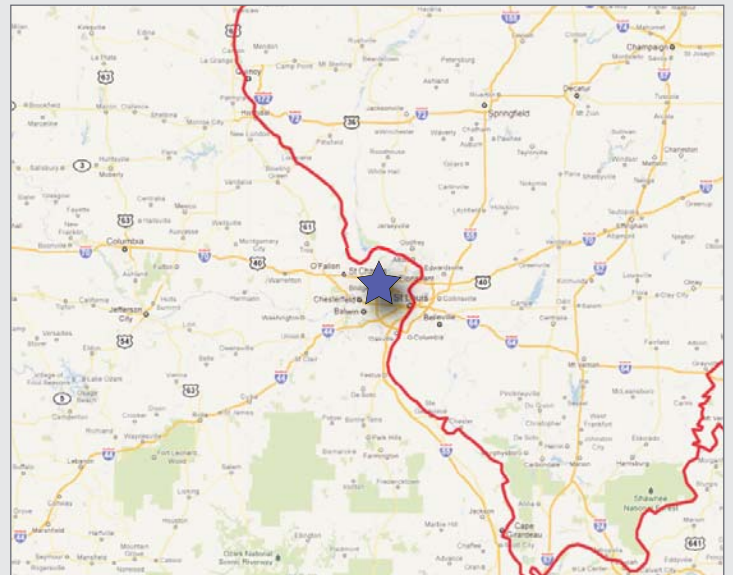

VINCE BAJARDI, CCIM
vbajardi@sansonegroup.com
JAKE CORRIGAN
jcorrigan@sansonegroup.com

120 S. Central, Suite 500
Saint Louis, MO 63105
p: 314.727.6664
f: 314.727.6101



Additional Information

Rendered view is for intent only and is an artistic rendering of proposed renovations.
Designs are subject to applicable plan review and approvals.

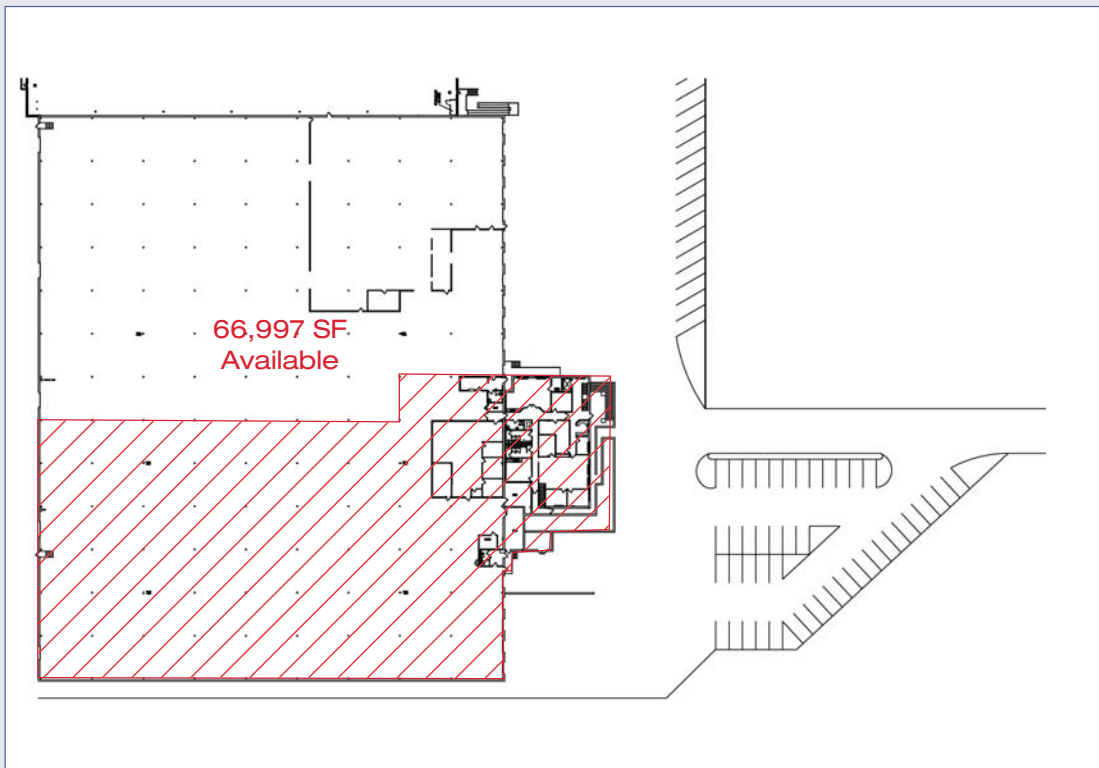

VINCE BAJARDI, CCIM
vbajardi@sansonegroup.com
JAKE CORRIGAN
jcorrigan@sansonegroup.com

120 S. Central, Suite 500
Saint Louis, MO 63105
p: 314.727.6664
f: 314.727.6101

